

# AL6-VA1 6" Architectural LED Downlight

Catalog #		Prepared by	LiteHarbor
Project		Date	
Notes			

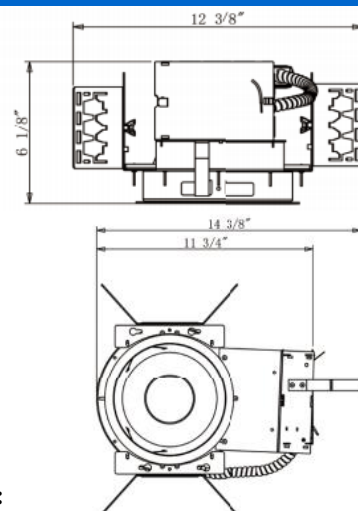

## 6" Architectural LED Downlight

### Description

- 1) Lighting is smooth and comfortable while using 50% less energy than the common CFL downlight.
- 2) Eco-friendly no lead or mercury
- 3) Designed to install into an existing downlights mounting frame and convert them into energy efficient LED downlights to save anywhere from 35% up to 75% on energy cost.
- 4) Ideal suited for use in commercial, retail and other architectural applications
- 5) Available with dedicated Emergency Battery Back-up

### Reflector

- 1) High quality reflector with 1.2mm thickness
- 2) Optional painted white flange is available

### Reflector Assembly

Reflector easily wires to dedicated frame with locking quick connect

### LED Module

Cree true white® technology available  
CRI>80%

Color temperature: 3000K-5000K

Rated for 50000 hours at 70% lumen output

### Order Matrix:

A	B	C	D	E	F	G
Item No.:AL6-VA1						

A	Series
AL6-VA1	6" Architectural Downlight LED

B	Input Voltage
	120V
##	277V
U	120-277V

C	LED Available
Cree	Cree
Citizen	Citizen
Epistar	Epistar
Seoul	Seoul
Osram	Osram



**Liteharbor Lighting Technology Co., Ltd.**

New Industry Area Hecun Danzao Town  
Nanhai Foshan City Guangdong China

TEL: +86-757-8180 8675

FAX: +86-757-8180 8685

E-mail: info@liteharbor.com

Website: www.liteharbor.com

Specifications subject to change w/o notice

Revision: Jan. 2015

No heat, mercury or UV

### Electrical System

Thermal protection guard protects the LED module from overheating and will dim LED module if necessary

PF>0.9

Fully dimmable down to 10% of initial light output with a 0-10 Volt dimmer

### Frame

Constructed from 16-gauge steel, die-formed construction for max heat dissipation and rust protection.

### Clearance

Frames require a minimum clearance of 3" ring from thermal insulation and 1/2" from adjacent building component.

### Mounting

- 1)Designed to install into an existing downlights mounting frame and convert them into energy efficient LED downlights.
- 2)Flex is designed to attach into existing junction box.
- 3)Vertically adjustable universal mounting brackets accept flat bar hangers, conduit or C channel.
- 4)The reflector assembly is held in with 4 "butter-fly" spring clips.
- 5)Reflector assy quickly attaches with lockable quick connect. Hanger bars ordered separately.
- 6)Compatible with C-channel, flat bar wood joist bar hanger and EMT

### Junction Box

- 1)Plaster frame integrated 29 cubic inch 0.064" thick galvanized steel
- 2)Provided with four 1/2" knockouts, one 3/4" knockout and four Romex knockouts with true pryout slots and strain clamps.
- 3)Designed for straight through conduit runs.
- 4)Electrical connections are made through a single junction box door.
- 5)Green wire provided for installation with ground wire fed through PVC pipe conduit.

### Thermal Protector

External thermal device is located on the junction box wrap.

D	Dimmable
	Non-Dimmable
DM	Dimmable

E	Lumen Output
1250	1250 Lumen
2000	2000 Lumen
3000	3000 Lumen

F	Color Temperature
30K	3000K
40K	4000K
50K	5000K

G	Options
EM	Emergency Backup
C	C-Channel Bar Hanger
F	Flat Bar Hanger
H	Wood Joist Bar Hanger

### Reflector Matrix

A	B	C
A	Trim	
SF	Self Flanged	
SFW	Self Flanged White	
	No Flange	
B	Reflector Finish	
C	Clear	
HZ	Haze	
WH	White	

C	Lens Type
CR	Clear Tempered
SB	Sand Blasted



**Liteharbor Lighting Technology Co., Ltd.**  
New Industry Area Hecun Danzao Town  
Nanhai Foshan City Guangdong China

TEL: +86-757-8180 8675  
FAX: +86-757-8180 8685  
E-mail: info@liteharbor.com

Website: www.liteharbor.com  
Specifications subject to change w/o notice  
Revision: Jan. 2015



## Driver

The LED driver is mounted to the J-box cover and is accessible from below the ceiling.

Rated for 50 to 60Hz at 120V/277V input

Produces less than 20% THD

## Listing & Warranty

ETL listed to US and Canada standards for wet locations

5-year limited warranty

Other Special Requirements Please Confirm with Factory

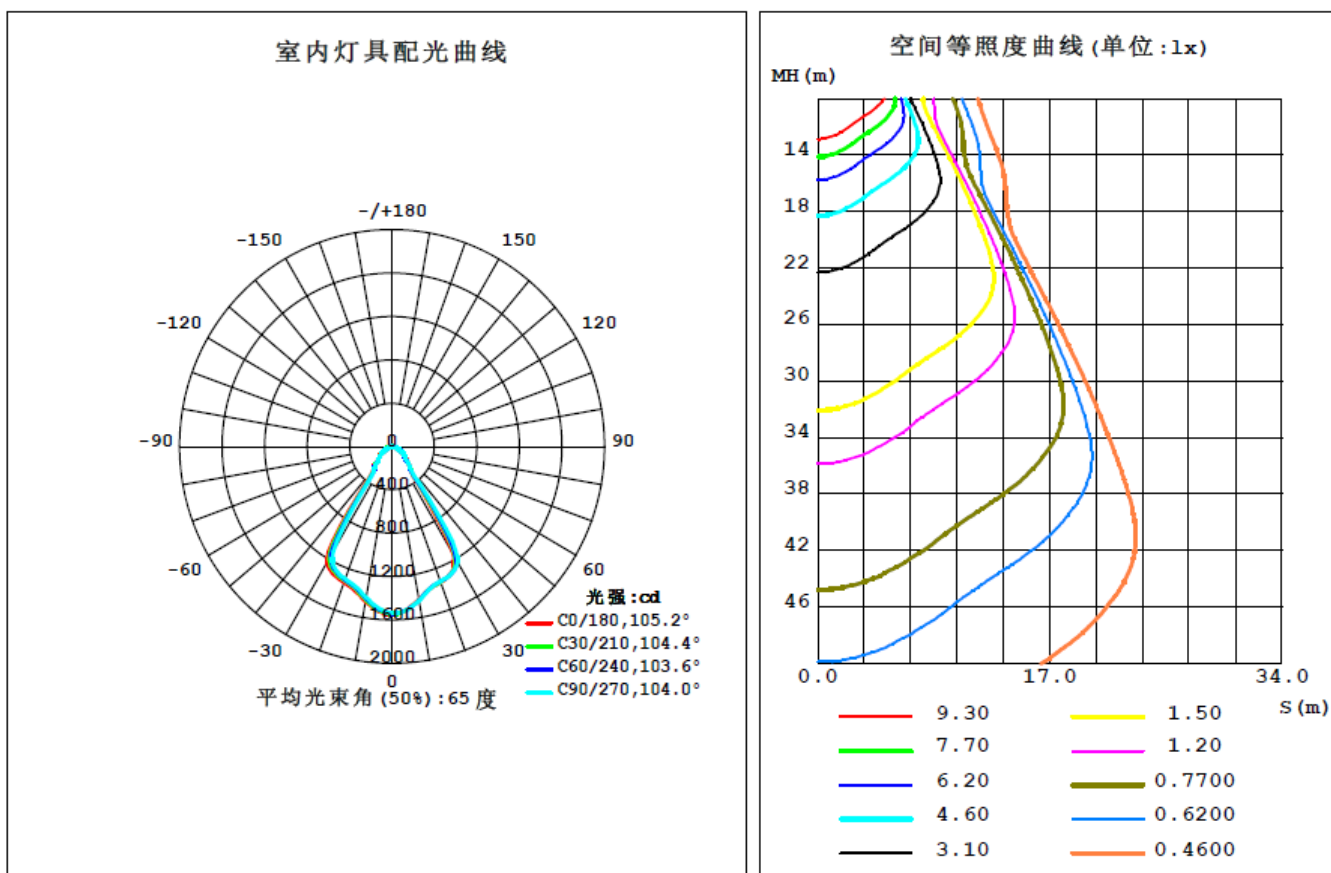

**Liteharbor Lighting Technology Co., Ltd.**

New Industry Area Hecun Danzao Town  
Nanhai Foshan City Guangdong China

TEL: +86-757-8180 8675

FAX: +86-757-8180 8685

E-mail: [info@liteharbor.com](mailto:info@liteharbor.com)

Website: [www.liteharbor.com](http://www.liteharbor.com)

Specifications subject to change w/o notice

Revision: Jan. 2015