

Y0903 OUTDOOR LANDSCAPE LIGHT

Catalog #		Prepared by	LiteHarbor
Project		Date	
Notes			



Order Matrix

A B C D E F G

Description

- 1) Available in white, black or bronze die-cast aluminum. 316 stainless steel is also available. Custom finishes available by special order.
- 2) 1" diameter machined aluminum stem with 1/2" NPT threads at each end. Stem length available in 24", 36" and 48" lengths
- 3) 90 degree adapter provides transition from fixture to stem.
- 4) High temperature silicone O-ring set screw provides water tight seal.
- 5) Easy re-lamping with lamp cover secured by a flush tamper-proof aiming and 360 degree of horizontal rotation
- 6) Integral knuckle provides 196 degree of vertical
- 7) Tamper proof socket head screws ensures precise aiming
- 8) Lamp cover is sealed with a staric O-ring.
- 9) Tempered glass lens is standard.
- 10) 1/2" pipe thread for mounting to junction box

Intergral Wiring

18AWG tefl on coated wire 600V rated 250°C

Hardware

Stainless steel tamper-proof sctews are flush mounted
Set of allen keys included with every fixture

Item No. Y0903	
-----------------------	--

A	Series
Y0903	Outdoor Landscape Light

B	Material & Finish
BK	Aliminum/black
WH	Aluminum/white
BR	Aluminum/bronze
SV	Aluminum/Silver
ST6	316 Stainless Steel
ST4	304 Stainless Steel

C	Stem Length
24"	24"
36"	36"
48"	48"

D	Lamp
MR16	MR16
GU10	GU10



OUTDOOR LIGHT



Liteharbor Lighting Technology Co., Ltd.
New Industry Area Hecun Danzao Town
Nanhai Foshan City Guangdong China

TEL: +86-757-8180 8675
FAX: +86-757-8180 8685
E-mail: info@liteharbor.com

Website: www.liteharbor.com
Specifications subject to change w/o notice
Revision: Jan. 2015

Accessories

- 1) Lens cap accommodates accessory holder .
Allows the use of up-to (3)1-5/8" media/color filters.
Must order separately.
- 2) Directional shield provides 45 degree cutoff
Available in aluminum or stainless steel

Lamp

1) COB LED

5W

2) Low voltage Halogen

MR16 lamp 12V 50W max GU5.3 socket

For use with 12V-AC remote transformer. Not included

3) MR16 LED

7W High brightness LED

Heat sinking: Integral to the fixture

Color temperature do at customers' needs

For use with 12V-AC remote transformer. Not included

4) HID Metal Halide

20W MR16MH GX10 Base

39W MR16MH GX10 Base

Remote Ballast:

Universal input 120V-277V

Maximum mounting distance=50 feet

Minimum starting temperature:-30°C

Maximum case temperature:80°C

Sound rating A

Warranty: up to 5 years

Voltage: Wide range input 108-305VAC

Frequency: 50/60Hz

Power factor > 95%

5) Line Voltage GU10 lamp is also Available

E	Wattage
L3	LED 3W
H50	Halogen 50W
M20	HID Metal Halide 20W

F	Color Temperature(LED)
27K	2700K
30K	3000K
35K	3500K
60K	6000K

G	Accessories
IPV100	45 °Cutoff directional shield

Other Special Requirements please Confirm with Factory

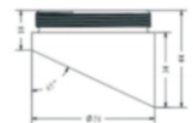

OUTDOOR LIGHT

